



**Waukesha  
Water  
Utility**

115 Delafield Street  
Waukesha, WI 53188  
Phone 262-521-5272  
Fax 262-521-5265

**REVISIONS**

description	by	date

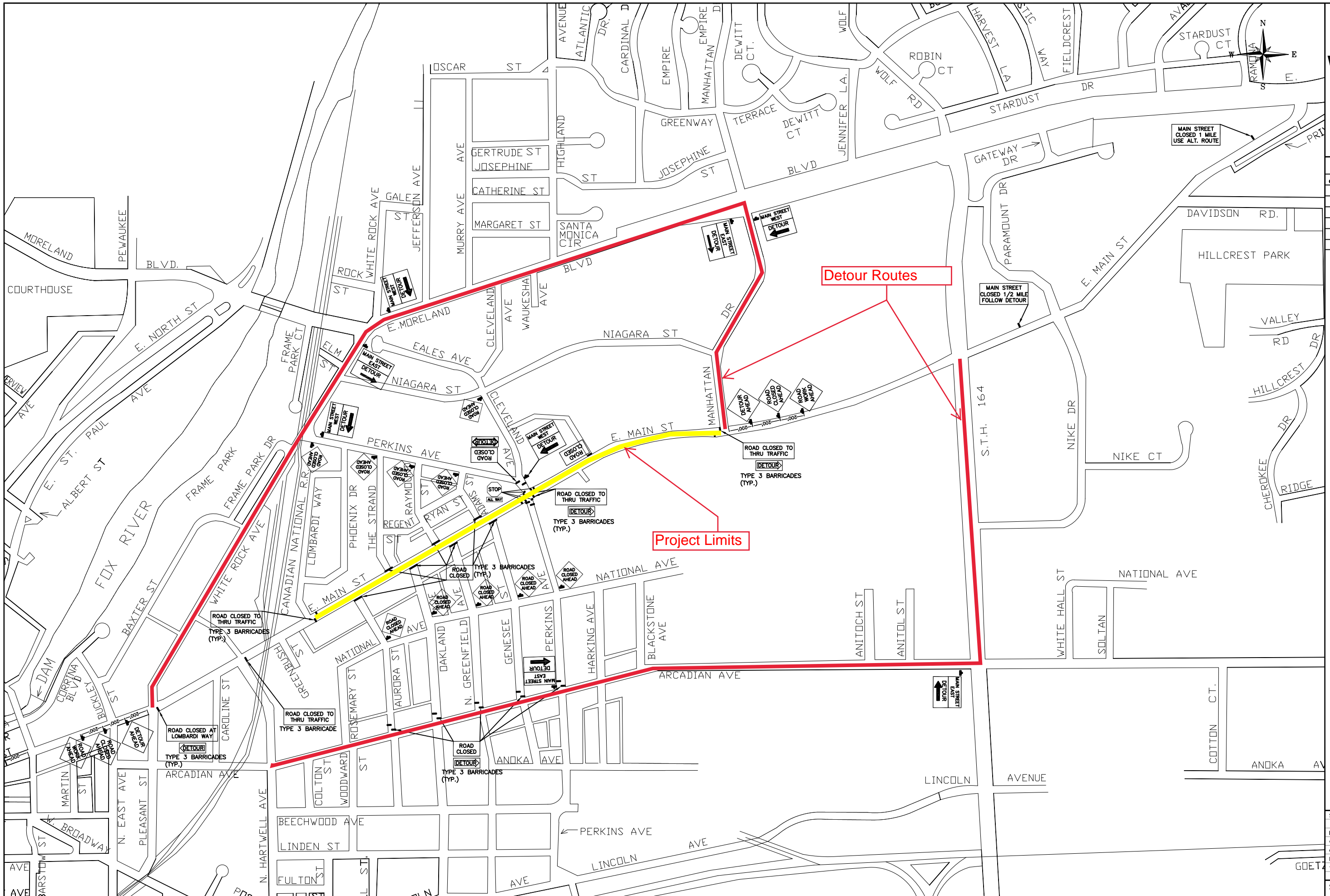

**Traffic Control Plan - Full Detour**  
**E. MAIN STREET**  
FROM: LOMBARDI WAY  
TO: MANHATTAN DRIVE

SCALE: 1" = NTS  
DATE: 1-31-2019  
drawn by : TAK  
checked : CJW  
project : GLCD0011  
file : /MAIN/2019/E. MAIN ST  
SHEET 99 of 100